

DS-7604NI-E1/4P and DS-7608NI-E2/8P (16P)

Introduction

DS-7600NI-E1/4P and DS-7600NI-E2/8P (16P) series NVR (Network Video Recorder) is a new generation recorder independently developed by Hikvision. It combines multiple advanced technologies such as audio and video decoding, embedded system, storage, network, and intelligence. It can work both as a stand-alone recorder and as an integrated component that cooperates with other devices to form a comprehensive surveillance system.

The DS-7600NI-E1/4P and DS-7600NI-E2/8P (16P) series NVRs are widely used in the areas of finance, public security, military, communication, transportation, education, etc.

Available Models

DS-7604NI-E1/4P
 DS-7608NI-E2/8P, DS-7616NI-E2/8P, DS-7632NI-E2/8P
 DS-7616NI-E2/16P, DS-7632NI-E2/16P

Main Features

- Ability to connect to third-party network cameras, including ACTI, Arecont, AXIS, Bosch, Brickcom, Canon, ONVIF, PANASONIC, Pelco, PSIA, SAMSUNG, SANYO, SONY, Vivotek, and ZAVIO
- 4/8/16/32 network cameras can be connected for different models
- Supports live view, storage, and playback of the connected camera(s) with up to 6 MP resolution
- Simultaneous HDMI and VGA outputs at up to 1920×1080 resolution
- New GUI, and supports starting recording with one key
- Multiple recording types: manual, continuous, alarm, motion, motion alarm, motion and alarm
- Instant playback for assigned channel during multi-channel display mode
- Customization of tags, searching, and playing back by tags
- Playback by sub-periods
- Locking and unlocking record files
- Supports HDD quota mode; different capacities can be assigned to different channels
- Up to two SATA hard disks up to 6 TB capacity each can be connected
- 1 self-adaptive 10M/100M/1000M network interface is provided
- Up to 4/8/16 independent PoE network interfaces for different models
- Supports Hikvision DDNS (Dynamic Domain Name System)
- Supports network detection, including network delay, packet loss, etc.
- Supports H.264+ to ensure high video quality with lowered bitrate

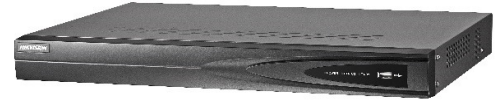

Typical Connections

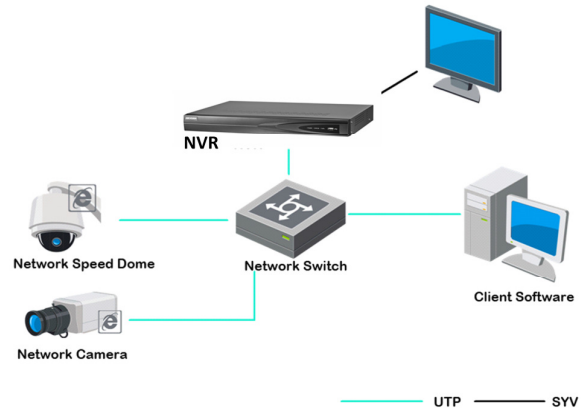

Specifications

Model		DS-7604NI-E1/4P	DS-7608NI-E2/8P
Video/Audio Input	IP Video Input	4-ch	8-ch
	Two-Way Audio Input	1-ch, RCA (2.0 Vp-p, 1k Ω)	
Network	Incoming Bandwidth	40 Mbps	80 Mbps
	Outgoing Bandwidth	80 Mbps	
	Remote Connection	32	128
Video/Audio Output	Recording Resolution	6 MP/5 MP/3 MP/1080p/UXGA/720p/VGA/4CIF/DCIF/2CIF/CIF/QCIF	
	Frame Rate	Main stream: 50 fps (P)/60 fps (N)	
		Sub-stream: 50 fps (P)/60 fps (N)	
	HDMI/VGA Output	1-ch, resolution: 1920 × 1080/60 Hz, 1600 × 1200/60 Hz, 1280 × 1024/60 Hz, 1280 × 720/60 Hz, 1024 × 768/60 Hz	
Audio Output	1-ch, RCA (linear, 1k Ω)		
Decoding	Live View/Playback Resolution	6 MP/5 MP/3 MP/1080p/UXGA/720p/VGA/4CIF/DCIF/2CIF/CIF/QCIF	
	Capability	4-ch @ 1080p	8-ch @ 720p, 6-ch @ 1080p
Hard Disk	SATA	1 SATA interface for 1 HDD	2 SATA interfaces for 2 HDDs
	Capacity	Up to 6 TB for each disk	
External Interface	Network Interface	1 RJ-45 10/100 Mbps self-adaptive Ethernet interface	1 RJ-45 10/1000 Mbps self-adaptive Ethernet interface
	USB Interface	1 × USB 2.0 and 1 × USB 3.0	
	Alarm In/Out (Optional)	4/1	
PoE	Interface	4 independent 100 Mbps PoE network interfaces	8 independent 100 Mbps PoE network interfaces
	Max. Power	50 W	120 W
	Supported Standard	AF and AT	
General	Power Supply	48 VDC	100 to 240 VAC
	Consumption (without hard disk or PoE)	≤10 W	
	Working Temperature	-10° C to +55° C (+14° F to +131° F)	
	Working Humidity	10 % to 90 %	
	Chassis	1U chassis	19-inch rack-mounted 1U chassis
	Dimensions (W × D × H)	315 mm × 230 mm × 45 mm (12.4" × 9.1" × 1.8")	445 mm × 290 mm × 45 mm (17.5" × 11.4" × 1.8")
	Weight (without hard disk)	≤ 1 kg (2.2 lb)	

Model		DS-7616NI-E2/8P	DS-7632NI-E2/8P	DS-7616NI-E2/16P	DS-7632NI-E2/16P
Video/Audio Input	IP Video Input	16-ch	32-ch	16-ch	32-ch
	Two-Way Audio Input	1-ch, RCA (2.0 Vp-p, 1k Ω)			
Network	Incoming Bandwidth	160 Mbps			
	Outgoing Bandwidth	80 Mbps			
	Remote Connection	128			
Video/Audio Output	Recording Resolution	6 MP/5 MP/3 MP/1080p/UXGA/720p/VGA/4CIF/DCIF/2CIF/CIF/QCIF			
	Frame Rate	Main stream: 50 fps (P)/60 fps (N)			
		Sub stream: 50 fps (P)/60 fps (N)			
	HDMI/VGA Output	1-ch, resolution: 1920 × 1080/60 Hz, 1600 × 1200/60 Hz, 1280 × 1024/60 Hz, 1280 × 720/60 Hz, 1024 × 768/60 Hz			
Audio Output	1-ch, RCA (linear, 1k Ω)				
Decoding	Live View/Playback Resolution	6 MP/5 MP/3 MP/1080p/UXGA/720p/VGA/4CIF/DCIF/2CIF/CIF/QCIF			
	Capability	16-ch @ 4CIF, 12-ch @ 720p, 6-ch @ 1080p			
Hard Disk	SATA	2 SATA interfaces for 2 HDDs			
	Capacity	Up to 6 TB for each disk			
External Interface	Network Interface	1 RJ-45 10/100/1000 Mbps self-adaptive Ethernet interface			
	USB Interface	1 × USB 2.0 and 1 × USB 3.0			
	Alarm In/Out (Optional)	4/1			
PoE	Interface	8 independent 100 Mbps PoE network interfaces		16 independent 100 Mbps PoE network interfaces	
	Maximum Power	120 W		200 W	
	Supported Standard	AF and AT			
General	Power Supply	100 to 240 VAC			
	Consumption (without hard disk or PoE)	≤10 W		≤15 W	
	Working Temperature	-10° C to +55° C (+14° F to +131° F)			
	Working Humidity	10% to 90%			
	Chassis	380 chassis			
	Dimensions (W × D × H)	380 mm × 290 mm × 48 mm (15.0" × 11.4" × 1.9")			
	Weight (without hard disk)	≤1 kg (2.2 lb)			

Physical Interfaces

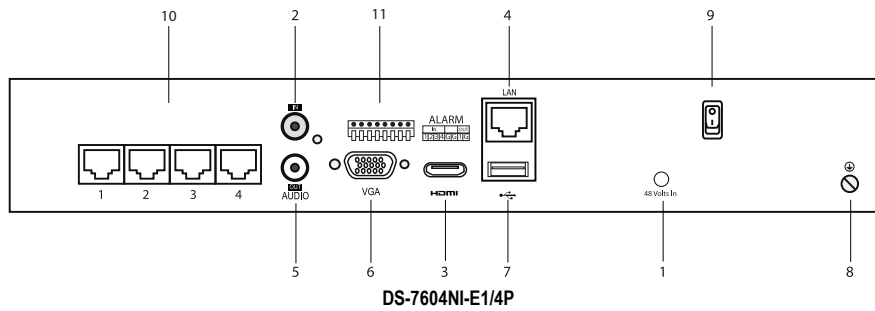

DS-7604NI-E1/4P

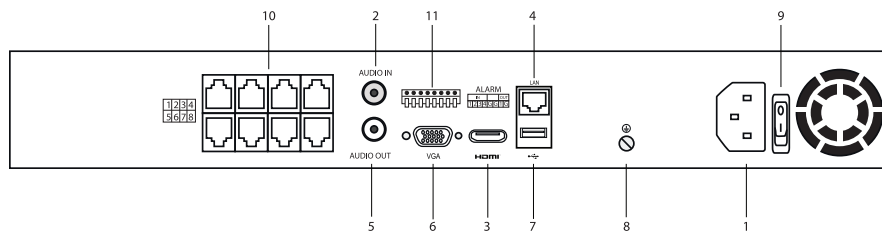

DS-7608NI-E2/8P

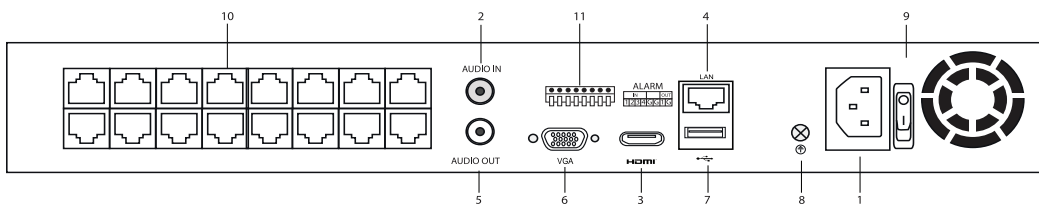

DS-7616NI-E2/16P



The rear panel of the DS-7616NI-E2/16P and DS-7632NI-E2/16P provides 16 independent 100 Mbps PoE network interfaces.

Index	Name
1	Power Supply
2	Audio In
3	HDMI Interface
4	LAN Network Interface
5	Audio Out
6	VGA Interface
7	USB Interface
8	Ground
9	Power Switch
10	Network Interfaces with PoE Function
11	Alarm I/O (4 in/1 out)

DS-2CD2122F-I(S)(W) (2.0MP)

DS-2CD2132F-I(S)(W) (3.0MP)



IR Fixed Dome Network Camera

604-760-5183 VanCityHD.com

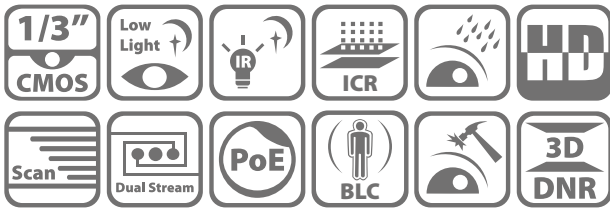

Key features

- 2MP / 3MP high resolution
- HD real-time video
- 3D DNR & DWDR & BLC
- IR LEDs: up to 30m
- IP66
- Vandal-proof
- PoE
- Onboard storage (up to 64GB)
- Wi-Fi optional

Dimensions

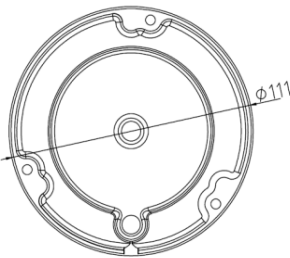
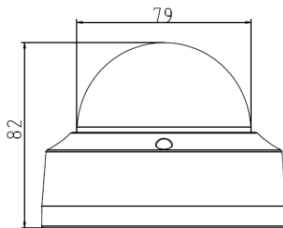

Available models

2.0MP:

- DS-2CD2122F-I, DS-2CD2122F-IS,
- DS-2CD2122F-IW, DS-2CD2122F-IWS

3.0MP:

- DS-2CD2132F-I, DS-2CD2132F-IS,
- DS-2CD2132F-IW, DS-2CD2132F-IWS

* 1.3MP model is also available -- DS-2CD2112F-I

* -S: Audio I/O interface, Alarm I/O interface.

-W: Built-in Wi-Fi

	DS-2CD2122F-I(S)(W)	DS-2CD2132F-I(S)(W)
Camera		
Image sensor	1/3" Progressive Scan CMOS	
Min. illumination	0.01 lux@F1.2, AGC ON, 0 lux with IR	0.07Lux @F1.2, AGC ON, 0 lux with IR
Shutter time	1/3s ~ 1/100,100s	
Lens	4mm @ F2.0 (2.8mm, 6mm optional) Angle of view: 98.5°(2.8mm), 79°(4mm), 49°(6mm)	4mm @ F2.0 (2.8mm, 6mm optional) 2048 × 1536: Angle of view: 86°(2.8mm), 70°(4mm), 43.3°(6mm) 1920 × 1080: Angle of view: 98.5°(2.8mm), 79°(4mm), 49°(6mm)
Lens mount	M12	
Angle adjustment	Pan: 0° ~ 355°, Tilt: 0° ~ 65°, Rotation: 0 ~ 360°	
Digital noise reduction	3D DNR	
Wide dynamic range	Digital WDR	
Day & night	IR cut filter with auto switch	
Compression Standard		
Video compression	H.264 / MJPEG	
H.264 codec profile	Main profile	
Bit rate	32 Kbps ~ 16 Mbps	
Dual stream	Yes	
Image		
Max. Image Resolution	1920 x 1080	2048 x 1536
Frame rate	50Hz: 25fps (1920 x 1080), 25fps (1280 x 720) 60Hz: 30fps (1920 x 1080), 30fps (1280 x 720)	50Hz: 20fps (2048 x 1536), 25fps (1920 x 1080), 25fps (1280 x 720) 60Hz: 20fps (2048 x 1536), 30fps (1920 x 1080), 30fps (1280 x 720)
Image settings	Saturation, brightness, sharpness, contrast, sharpness adjustable through client software or web browser	
BLC	Yes, zone configurable	
ROI	Yes, up to 3 configurable areas	
Network		
Network storage	Local storage: Built-in Micro SD/SDHC/SDXC card slot, up to 64 GB ; NAS	
Alarm trigger	Face detection, line crossing detection, intrusion detection, scene change detection, Motion detection, Dynamic Analysis, Tampering alarm, Network disconnect, IP address conflict, Storage full, Storage error	
Protocols	TCP/IP, ICMP, HTTP, HTTPS, FTP, DHCP, DNS, DDNS, RTP, RTSP, RTCP, PPPoE, NTP, UPnP, SMTP, SNMP, IGMP, 802.1X, QoS, IPv6, Bonjour	
System compatibility	ONVIF, PSIA, CGI, ISAPI	
General functionalities	User Authentication, Watermark	
General function	Flickerless, dual stream, heartbeat, mirror, password protection, watermark	
Interface		
Communication Interface	1 RJ45 10M/100M Ethernet interface	
Wi-Fi Specification (Only for -W model)		
Wireless Standards	IEEE802.11b, 802.11g, 802.11n Draft	
Frequency Range	2.4 GHz ~ 2.4835 GHz	
Channel Bandwidth	20/40MHz Support	
Protocols	802.11b: CCK, QPSK, BPSK ; 802.11g/n: OFDM	
Security	64/128-bit WEP, WPA/WPA2, WPA-PSK/WPA2-PSK, WPS	
Transmit Output Power	11b: 17±1.5dBm @ 11Mbps ; 11g: 14±1.5dBm @ 54Mbps ; 11n: 12.5±1.5dBm	
Receive Sensitivity	11b: -90dBm @ 11Mbps (Typical) ; 11g: -75dBm @ 54Mbps (Typical) ; 11n: -74dBm (Typical)	
Transfer Rates	11b: 11Mbps ; 11g: 54Mbps ; 11n: up to 150Mbps	
Wireless Range	Outdoor: 200m, Indoor: 50m ; *The performance varies based on actual environment.	
Wireless Standards	IEEE802.11b, 802.11g, 802.11n Draft	
General		
Operating conditions	-30 °C ~ 60 °C (-22 °F ~ 140 °F) ; Humidity 95% or less (non-condensing)	
Power supply	12V DC ± 10% ; PoE (802.3af)	
Power consumption	Max. 5 W (Max. 7 W with IR cut filter on)	
Impact protection	IEC60068-2-75Eh, 20J; EN50102, up to IK10 -W: En50102, up to IK8	
Ingress protection	IP66	
IR range	30 meters	
Dimensions	Φ111 × 82 (4.4" × 3.2")	
Weight	500g (1.1 lbs)	

604-760-5183 VanCityHD.com